

Control Panel: Recognizing Microphone Input

What will be covered:

- How to test if my microphone is working.
-

1. Open the Start Menu

Press the **Windows** key on your keyboard to bring up the Start Menu.

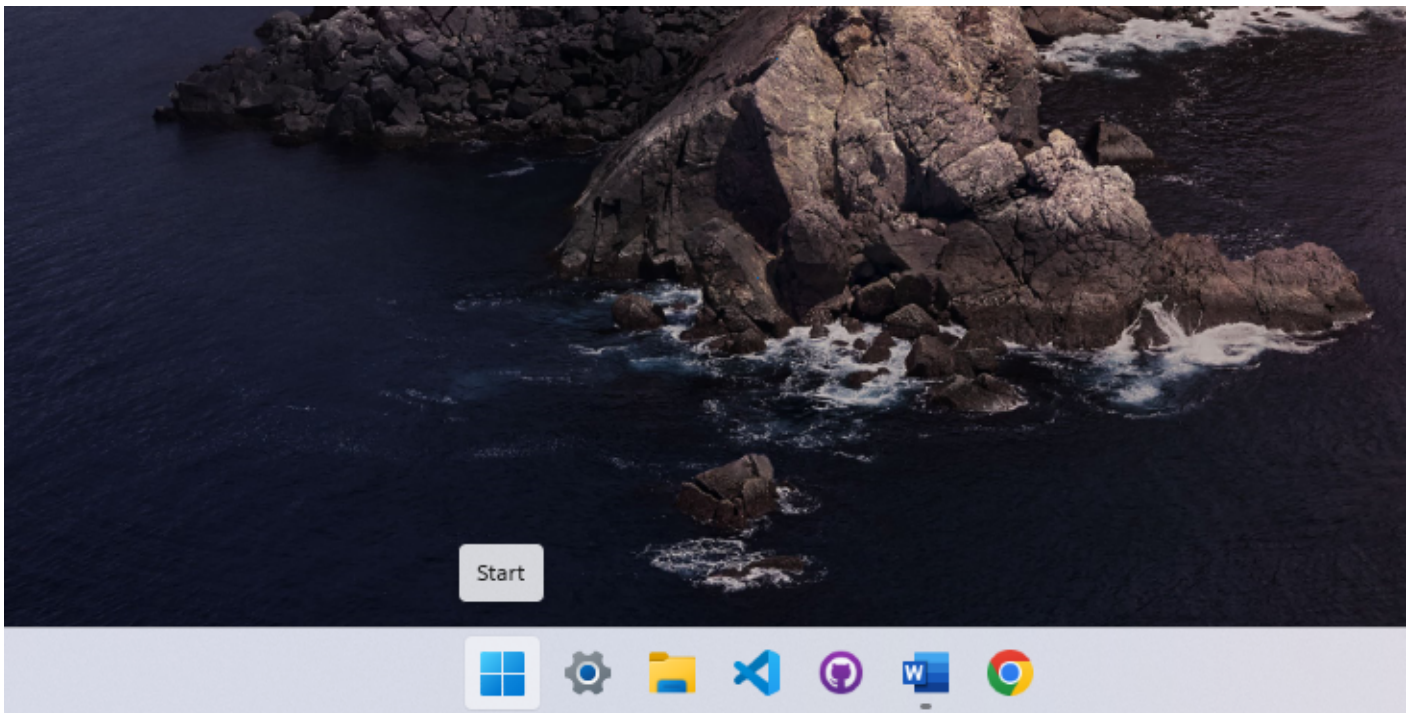

2. Search for Control Panel

Type **Control Panel** in the search bar, then press **Enter** to open it.

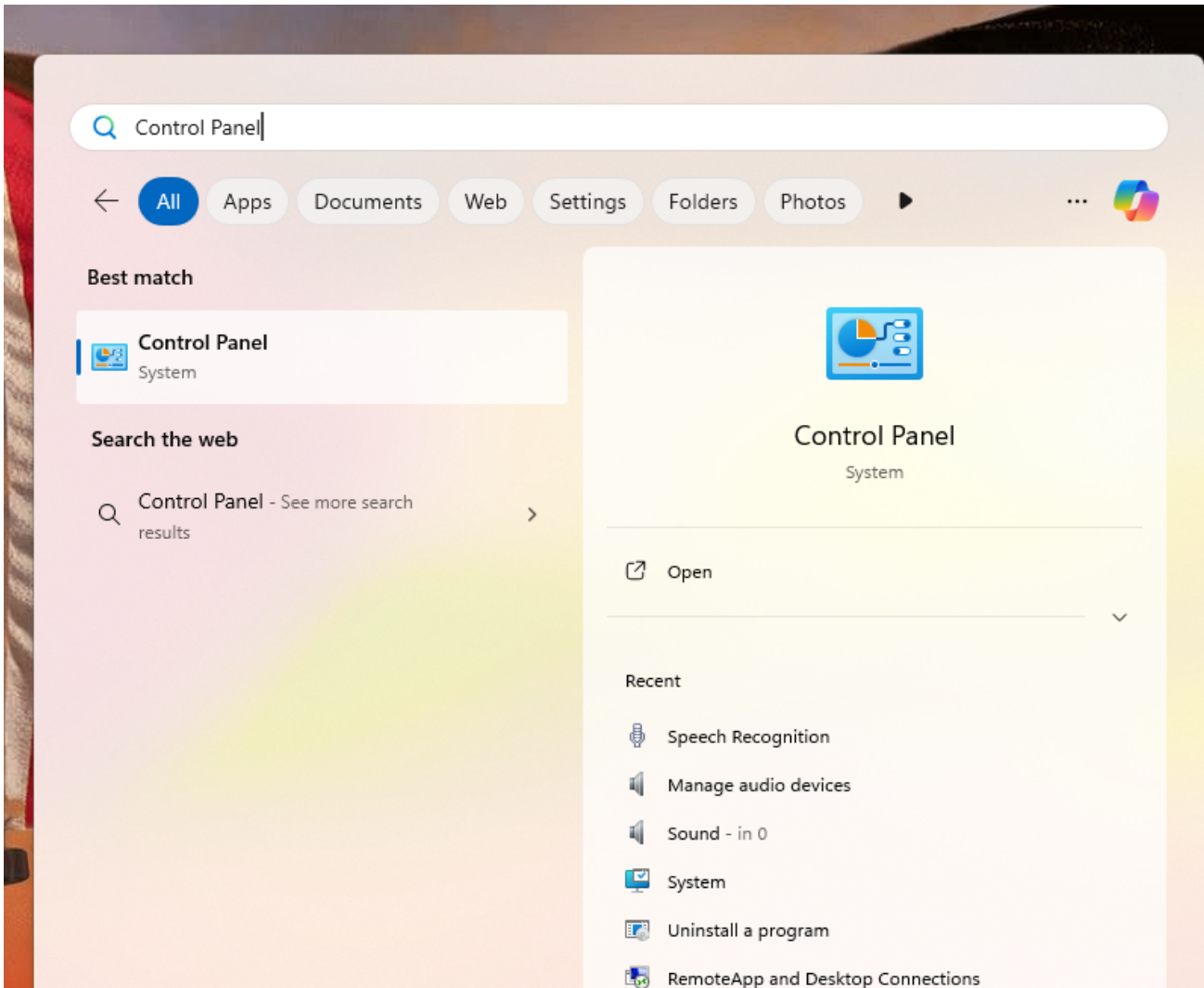

3. Open Ease of Access Tab

Once Control Panel has opened, Locate the **Ease of access** tab.

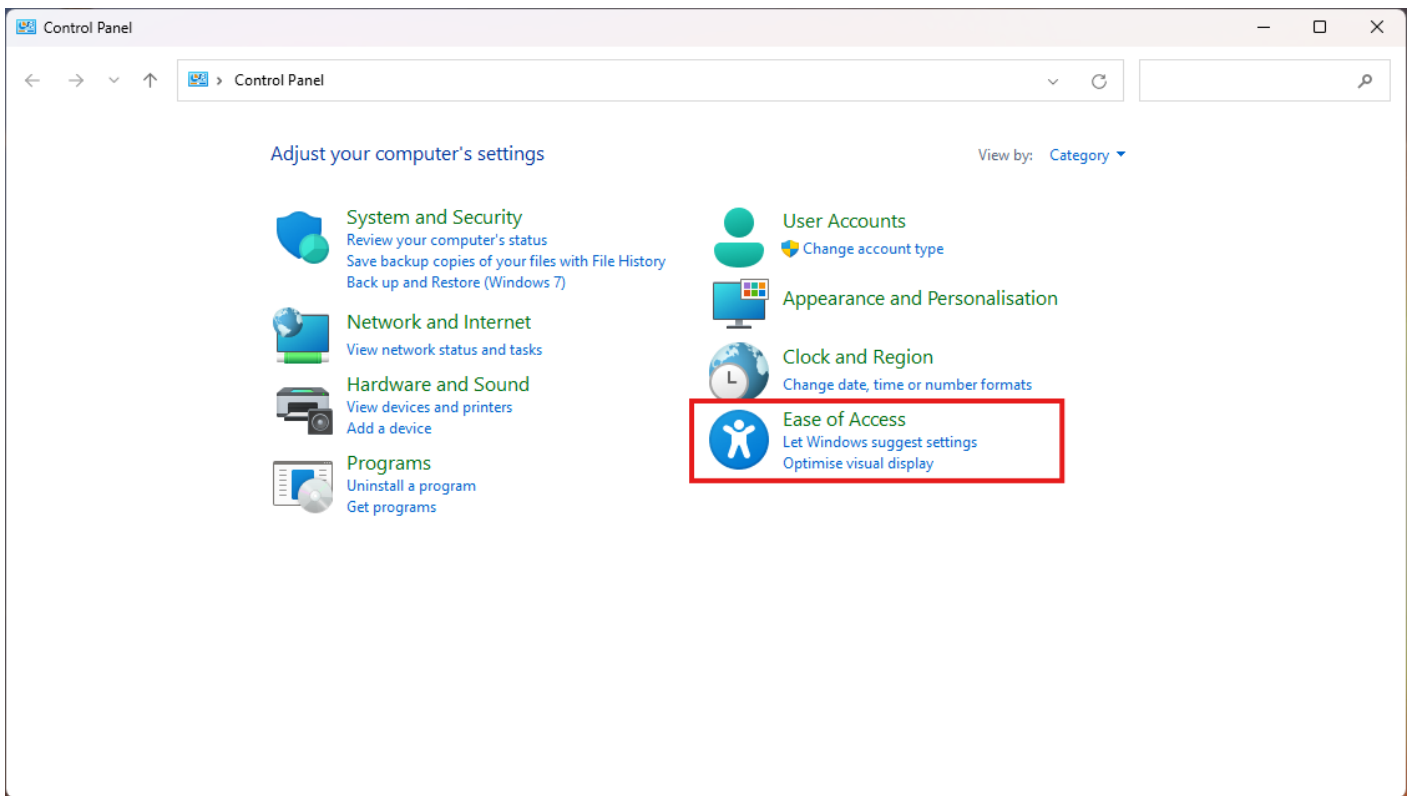

4. Open Speech Recognition

Click "**Speech Recognition**"

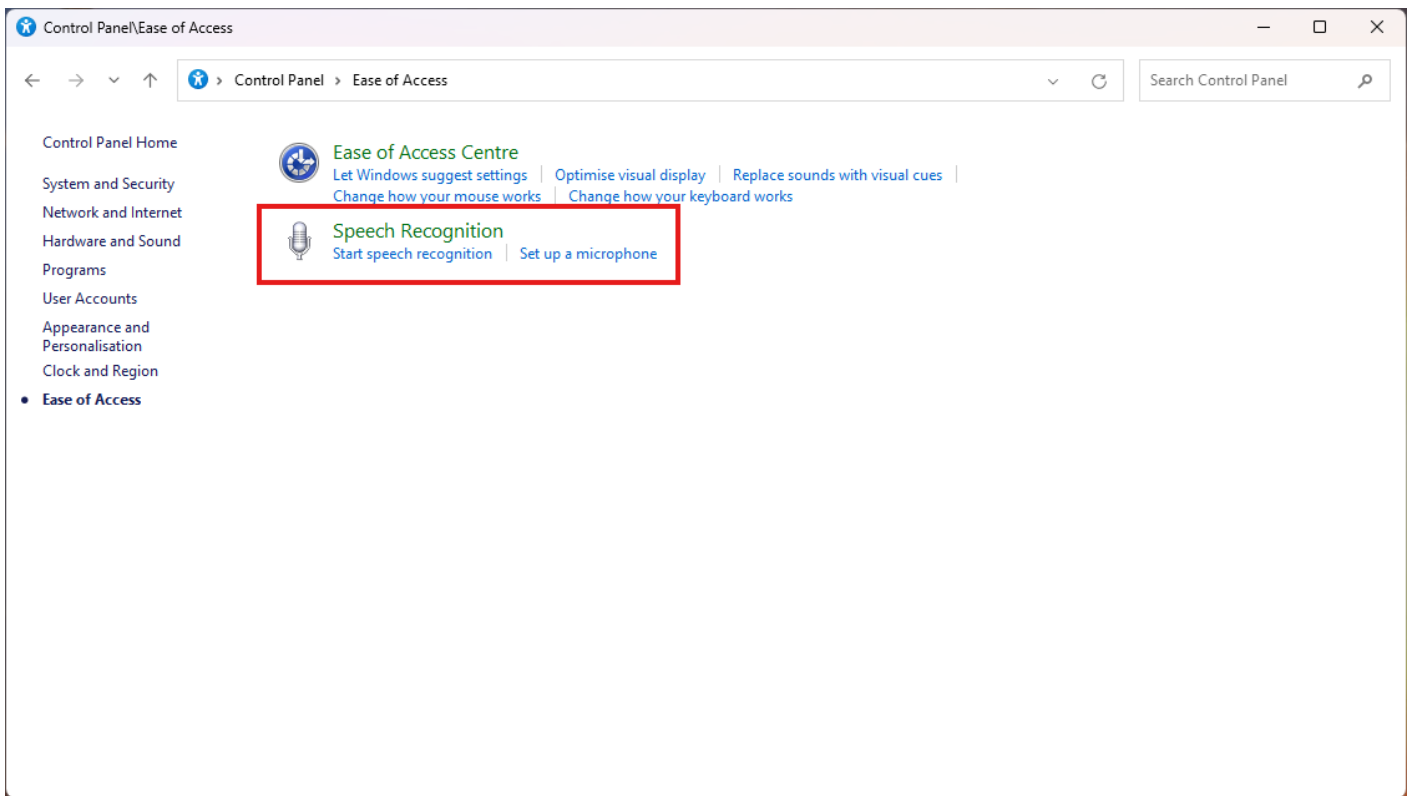

5. Set up Microphone

Click "**Set up Microphone**"

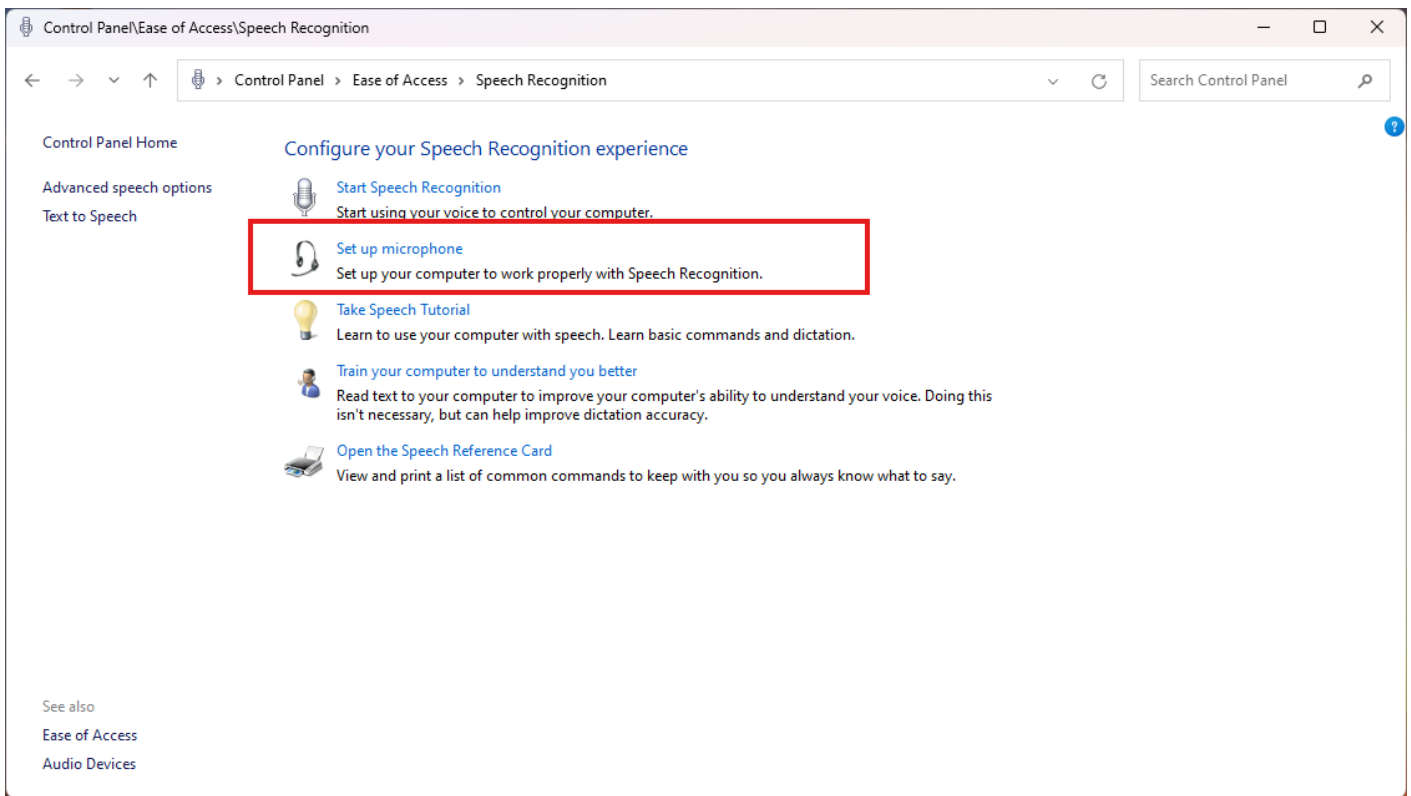

6. Microphone Device

Windows will auto-detect the microphone you have connected to the computer. Select the **relevant** Microphone device.

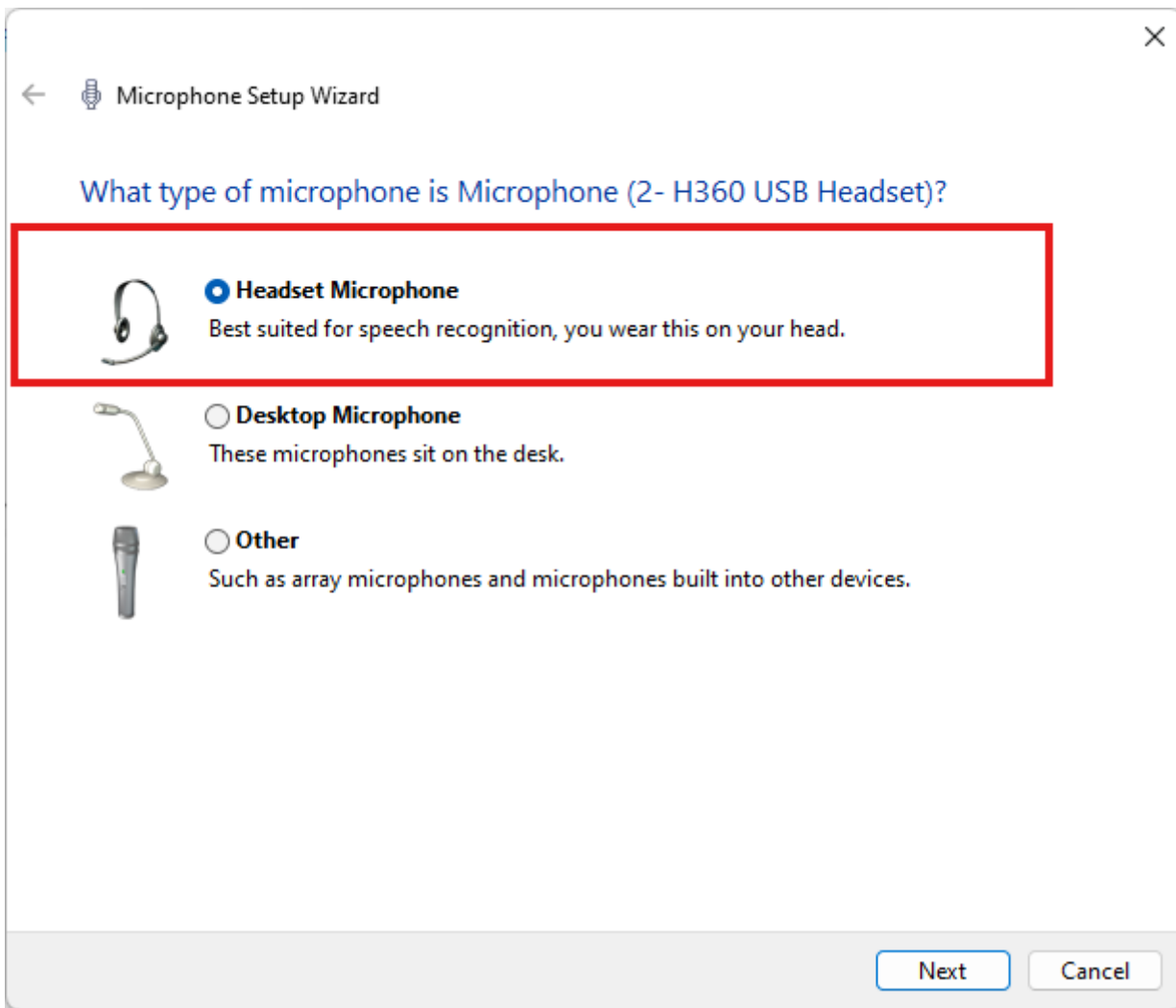

7. Test Audio Input

Now test the microphone. the sound level bar should go up and down based on your voice frequency picked up by the microphone. **Red**: Too loud, **Green**: Good Sound Level, **Yellow**: Quite. If you aren't any getting audio input the sound level would stay still at the bottom.



Adjust the volume of Microphone (2- H360 USB Headset)



Read the following sentences aloud in a natural speaking voice:

"Peter dictates to his computer. He prefers it to typing, and particularly prefers it to pen and paper."



Note: After reading this, you can proceed to the next page.

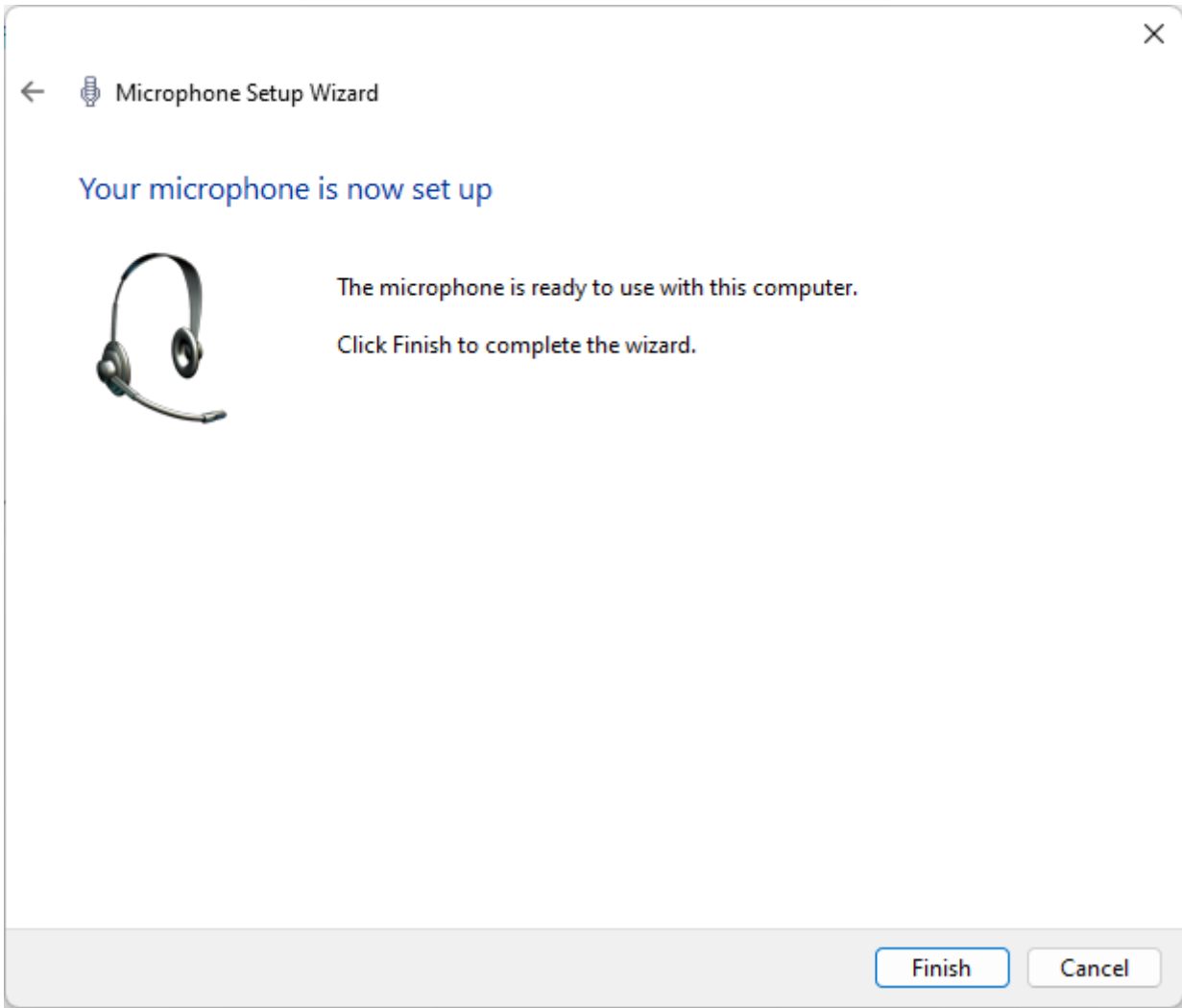

Revision #7

Created 24 January 2025 10:54:06 by Broadband9Admin

Updated 21 February 2025 15:04:50 by Broadband9Admin